

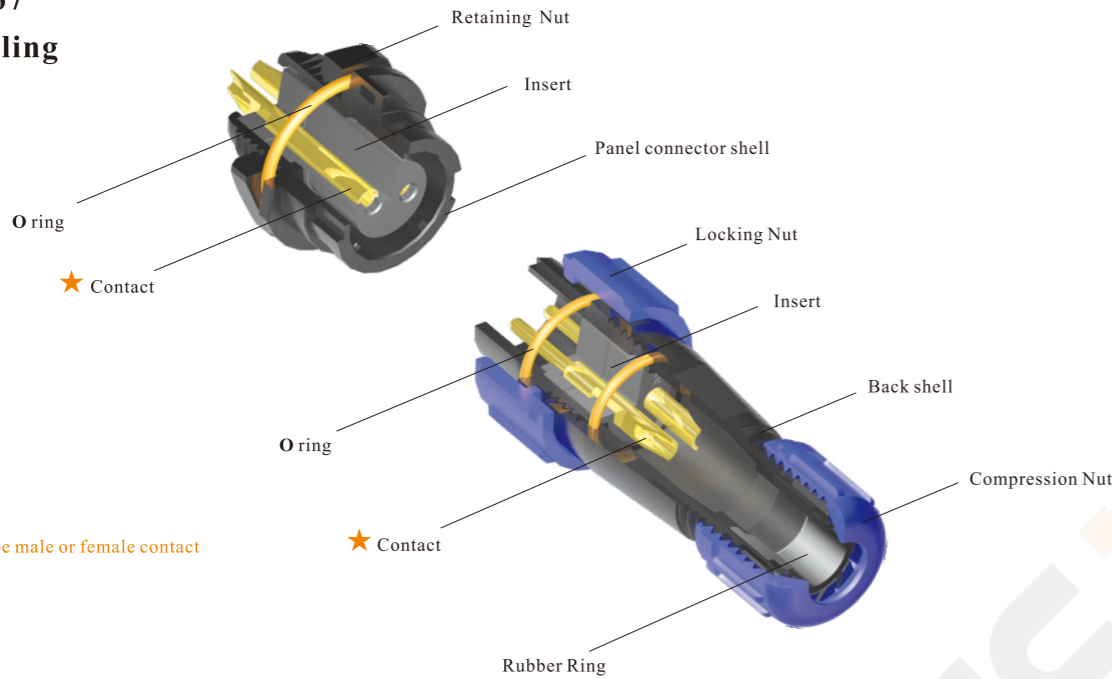

- SY Series IP67
- Bayonet coupling



Material and spec

Coupling	Bayonet	
Shell material	PC, Nylon66, fire resistance: V-0	
Insert material	PPS, max temperature 260 °C	
Contact material	Brass with gold plating	
Termination	Solder: SY11, SY13, SY17, SY21, SY25, SY29 Crimp: SY17, SY21, SY25, SY29 Screw: SY21, SY25, SY29(Ø2.5, Ø3, Ø3.5mm contact)	
Cable outer diameter range	SY11: I:3-4mm, II:4-6.5mm SY17: 6-10mm SY25: I:10-14mm, II: 7-12mm	SY13: I: 4-6.5mm, II: 5-8mm SY21: I: 4.5-7mm, II: 7-12mm III: 5-9mm SY29: I: 9-13mm, II: 13-16mm
IP rating	IP67	
Mating cycle	500	
Temperature range	-40°C ~ +85°C; SY25 Data: -20°C ~ +70°C	
Insulation resistance	2000 MΩ	

SY11 Series



SY1110 / P — Male contact
SY1110 / S — Female contact

Cable connector
Mate with SY1111,
SY1111C, SY1112

Cable outer diameter range
I: 3-4mm, II: 4-6.5mm
Number of contact
Female contact

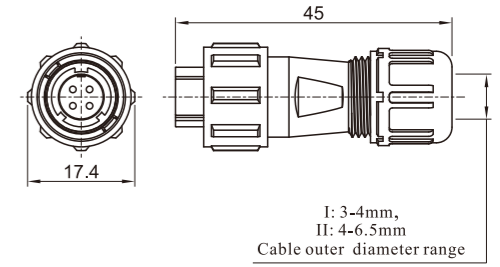

SY1111C / P — Male contact
SY1111C / S — Female contact

In-line cable connector C
Mate with SY1110

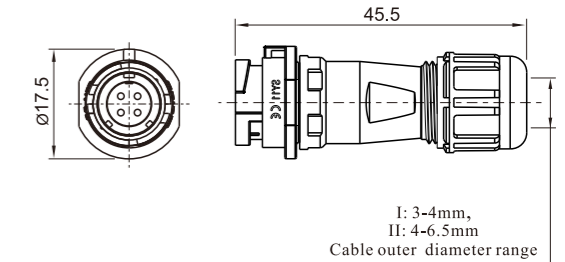

SY1112 / P — Male contact
SY1112 / S — Female contact

Rear-nut mount
Mate with SY1110

Number of contact

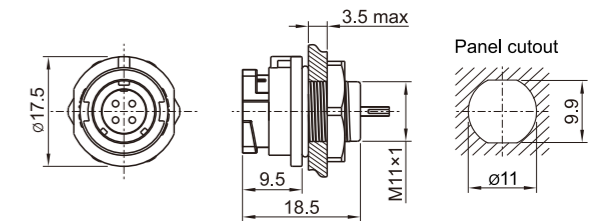

Solder contact spec

Number of contact	2	3	4	5
Male contact face view				
Rated current (A)	5	5	3	3
Contact diameter(mm)	Ø1×2	Ø1×3	Ø0.7×4	Ø0.7×5
Rated voltage (AC.V)	180	180	125	125
Test voltage(AC.V) 1 min	1000	1000	1000	1000
Contact resistance(mΩ)	5	5	10	10
Wire size(mm ² /AWG)	≤0.75/18	≤0.75/18	≤0.5/20	≤0.5/20

SY 11

SY11 Series



Cable connector
Mate with SY1111, SY1112

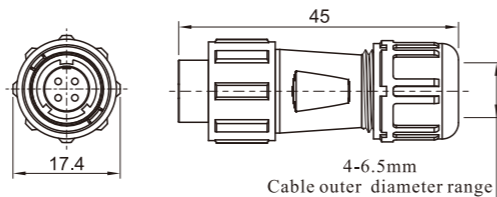

SY1110/P — Male contact
SY1110/S — Female contact

(CU):
Colour: All black
Number of contact
Female contact

SY 13

SY13 Series



Cable connector
Mate with SY1311, SY1311C, SY1312

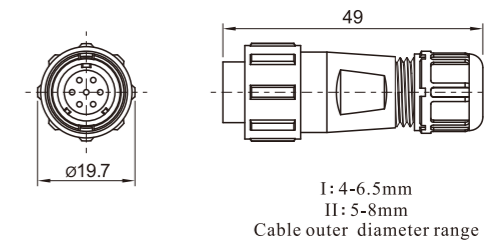

SY1310 / P — Male contact
SY1310 / S — Female contact

Cable outer diameter range
I: 4-6.5mm , II: 5-8mm
Number of contact
Female contact



In-line cable connector
Mate with SY1110

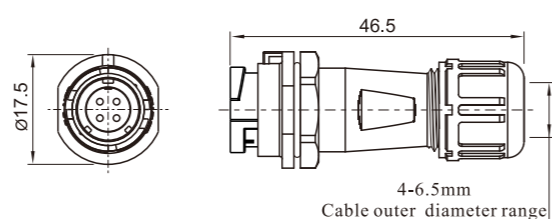

SY1111/P — Male contact
SY1111/S — Female contact



In-line cable connectorC
Mate with SY1310

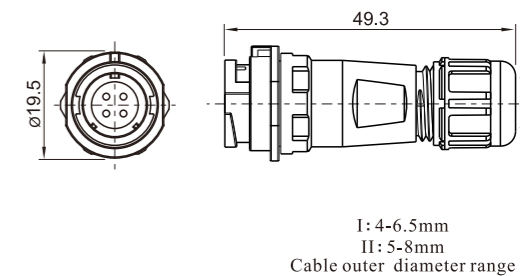

SY1311C / P — Male contact
SY1311C / S — Female contact

I: 4-6.5mm
II: 5-8mm
Cable outer diameter range

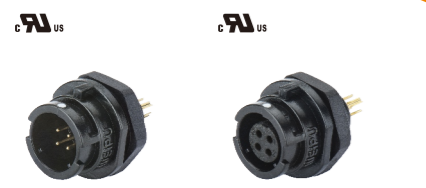

Rear-nut mount
Mate with SY1110

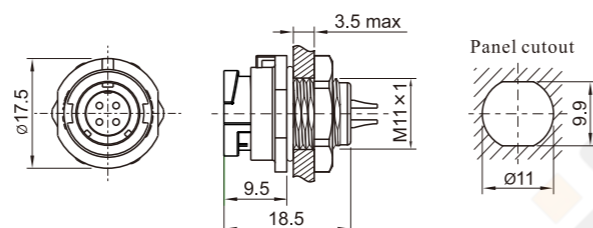

SY1112/P — Male contact
SY1112/S — Female contact



Rear-nut mount
Mate with SY1310

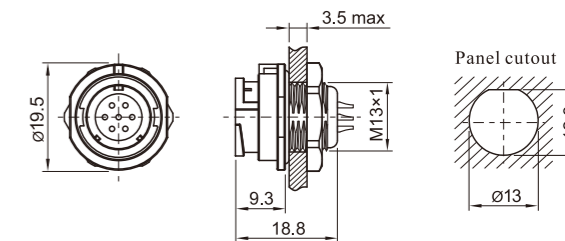

SY1312 / P — Male contact
SY1312 / S — Female contact

Number of contact

Solder contact spec

Number of contact	4	5
Male contact face view		
Rated current (A)	3	3
Contact diameter(mm)	Ø0.7×4	Ø0.7×5
Rated voltage (AC.V)	125	125
Test voltage(AC.V) 1 min	1000	1000
Contact resistance(mΩ)	10	10
Wire size(AWG)	20	20

Solder contact spec

Number of contact	2	3	4	5	6	7	9
Male contact face view							
Rated current (A)	13	13	5	5	5	5	3
Contact diameter (mm)	Ø1.6X2	Ø1.6X3	Ø1X4	Ø1X5	Ø1X6	Ø1X7	Ø0.7X9
Rated voltage (AC.V)	250	250	200	180	125	125	125
Test voltage(AC.V) 1 min	1500	1500	1500	1000	1000	1000	1000
Contact resistance (mΩ)	2.5	2.5	5	5	5	5	10
Wire size (mm ² / AWG)	≤2/14	≤2/14	≤0.75/18	≤0.75/18	≤0.75/18	≤0.75/18	≤0.5/20

SY13 Series

**SY
13**



Cable connector
Mate with SY1311, SY1312

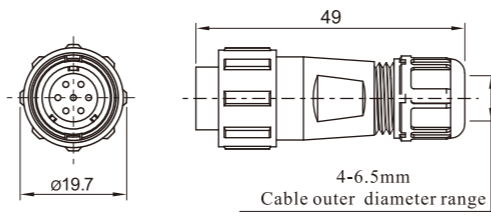

SY1310/P — SY1310/S

(CU):
Colour: All black

Male contact
Number of contact
Female contact

06



In-line cable connector
Mate with SY1310

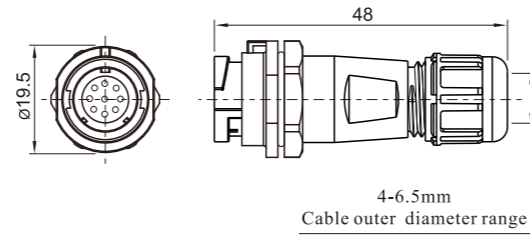

SY1311/P — SY1311/S



Rear-nut mount
Mate with SY1310

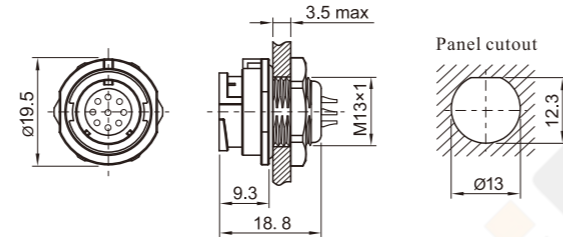

SY1312/P — SY1312/S

(CU):
Number of contact

Solder contact spec

Number of contact	9
Male contact face view	
Rated current (A)	3
Contact diameter (mm)	Ø0.7X9
Rated voltage (AC.V)	125
Test voltage(AC.V) 1 min	1000
Contact resistance (mΩ)	10
Wire size (AWG)	20

SY17 Series

**SY
17**



Cable connector
Mate with SY1711,
SY1711C, SY1712

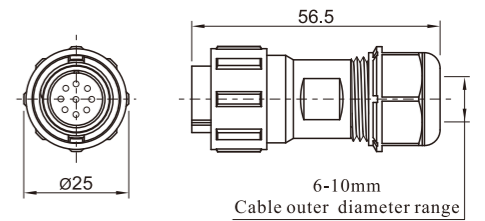

SY1710/P — SY1710/S

1: solder, 3: crimp
Number of contact
Female contact

Male contact

06



In-line cable connector C
Mate with SY1710

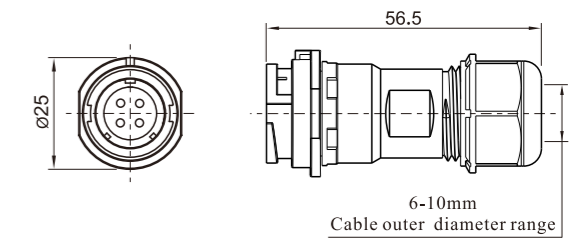

SY1711C/P — SY1711C/S



Rear-nut mount
Mate with SY1710

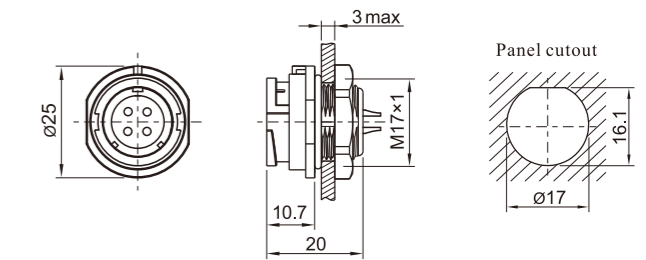

SY1712/P — SY1712/S

Solder contact spec

Number of contact	2	3	4	2B	3B	4B	5	7	9	10
Male contact face view										
Rated current (A)	10	10	5	15	15	15	5	5	5	5
Contact diameter(mm)	Ø1.5X2	Ø1.5X3	Ø1X4	Ø2X2	Ø2X3	Ø2X4	Ø1X5	Ø1X7	Ø1X9	Ø1X10
Rated voltage (AC.V)	500	500	500	500	500	500	500	400	400	400
Test voltage(AC.V) 1 min	1500	1500	1500	1500	1500	1500	1500	1200	1200	1200
Contact resistance (mΩ)	2.5	2.5	5	2.5	2.5	2.5	5	5	5	5
Wire size (mm ² /AWG)	≤2/14	≤2/14	≤0.75/18	≤2/14	≤2/14	≤2/14	≤0.75/18	≤0.75/18	≤0.75/18	≤0.75/18

SY21 Series

**SY
21**



Cable connector
Mate with SY2111, SY2111C,
SY2112, SY2113

SY2110 / P --- SY2110 / S

Male contact
Female contact
Number of contact

1: solder, 2: screw, 3: crimp

Cable outer diameter range
I: 4.5-7mm, II: 7-12mm, III: 5-9mm

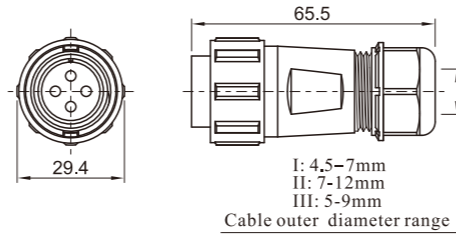

Angled cable connector
Mate with SY2111, SY2111C, SY2112, SY2113

SY2116 / P --- SY2116 / S

Number of contact

1: solder, 2: screw, 3: crimp

Cable outer diameter range
I: 4.5-7mm, II: 7-12mm, III: 5-9mm

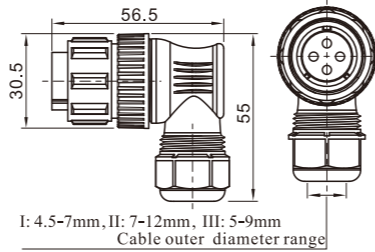

In-line cable connector C
Mate with SY2110, SY2116

SY2111C / P --- SY2111C / S

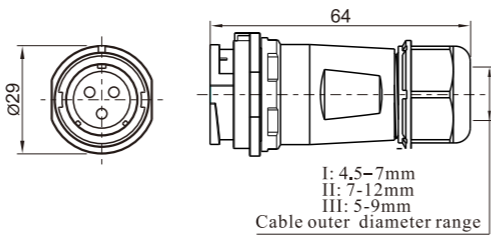

Rear-nut mount
Mate with SY2110, SY2116

SY2112 / P --- SY2112 / S

Number of contact

1: solder, 2: screw, 3: crimp

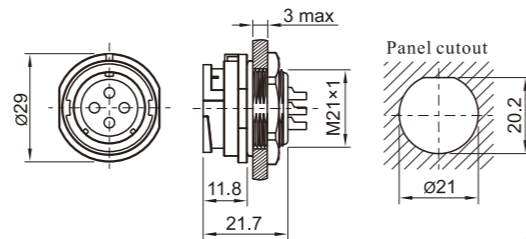

2-hole flange
Mate with SY2110, SY2116

SY2113 / P --- SY2113 / S

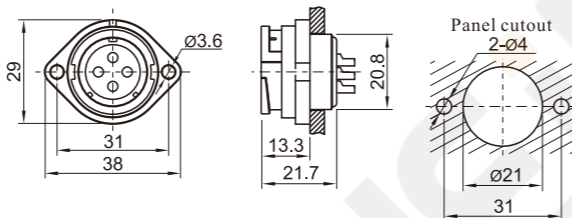

SY25 Series

NEW

**SY
25**



Cable connector
Mate with SY2511, SY2511C,
SY2512, SY2513

SY2510 / P --- SY2510 / S

Male contact
Female contact
Number of contact

1: solder, 2: screw, 3: crimp

Cable outer diameter range
I: 10-14mm

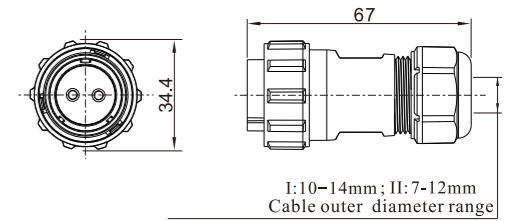

In-line cable connector C
Mate with SY2510

SY2511C / P --- SY2511C / S

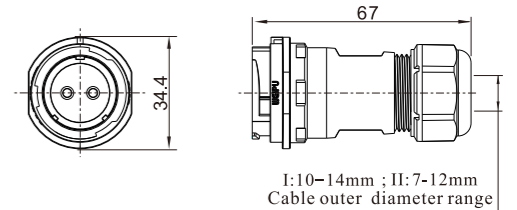

Rear-nut mount
Mate with SY2510

SY2512 / P --- SY2512 / S

Number of contact

1: solder, 2: screw, 3: crimp

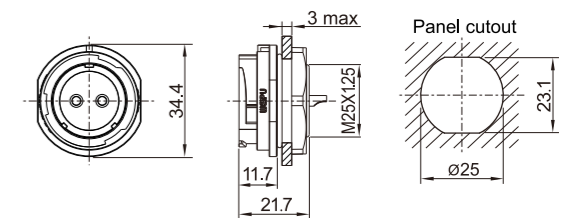

2-hole flange
Mate with SY2510

SY2513 / P --- SY2513 / S

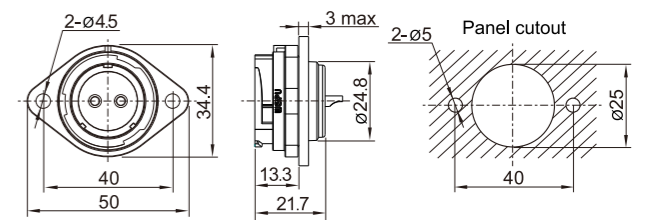

Front-nut mount
Mate with SY2510

SY2515 / P --- SY2515 / S

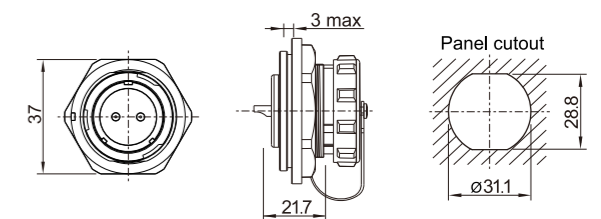

Solder contact spec

★Crimp contact spec see P20

★Screw contact spec see P21

Number of contact	2	3	4	5	5B	5C	6	6B	7	8	9	12	15
Male contact face view													
Rated current (A)	30	30	30	30	30 5	15	25 5	30 5	15	10	5	5	5
Contact diameter (mm)	Ø3X2	Ø3X3	Ø3X4	Ø3X5	Ø3X2 Ø1X3	Ø2X5	Ø2.5X4 Ø1X2	Ø3X2 Ø1X4	Ø2X7	Ø1.5X8	Ø1X9	Ø1X12	Ø1X15
Rated voltage (AC.V)	500	500	500	500	500	500	500	500	500	500	400	400	400
Test voltage(AC.V) 1 min	1500	1500	1500	1500	1500	1500	1500	1500	1500	1500	1200	1200	1200
Contact resistance (mΩ)	1	1	1	1	1 5	2.5	1 5	1 5	2.5	2.5	5	5	5
Termination	solder / screw	solder / screw	solder / screw	solder / screw	solder	solder	solder	solder	solder	solder	solder	solder	solder
Wire size for solder (mm ² / AWG)	≤4/11	≤4/11	≤4/11	≤4/11	≤4/11 ≤0.75/18	≤2/14	≤4/11 ≤0.75/18	≤4/11 ≤0.75/18	≤2/14	≤2/14	≤0.75/18	≤0.75/18	≤0.75/18
Wire size for screw termination (mm ² / AWG)	≤1.5/15	≤1.5/15	≤1.5/15	≤1.5/15	/	/	/	/	/	/	/	/	/

Solder contact spec

★Crimp contact spec see P20

★Screw contact spec see P21

Number of contact	2	3	4	9	10	12	12B	19
Male contact face view								
Rated current (A)	25	25	25	5 25	10	10	5 30	5
Contact diameter(mm)	Ø2.5X2	Ø2.5X3	Ø2.5X4	Ø1X5 Ø2.5X4	Ø1.5X10	Ø1.5X12	Ø1X9 Ø3X3	Ø1X19
Rated voltage (AC.V)	500	500	500	500	500	500	500	400
Test voltage(AC.V) 1 min	1500	1500	1500	1500	1500	1500	1500	1200
Contact resistance (mΩ)	1	1	1	5 1	2.5	2.5	5 1	5
Insulation resistance (MΩ)	2000	2000	2000	2000	2000	2000	2000	2000
Wire size (mm ² / AWG)	≤4/11	≤4/11	≤4/11	≤0.75/18 ≤4/11	≤2/14	≤2/14	≤0.75/18 ≤4/11	≤0.75/18

SY25 Series



SY25



Plug with LC adapter
Mate with SY2511, SY2511C,
SY2512, SY2513, SY2515

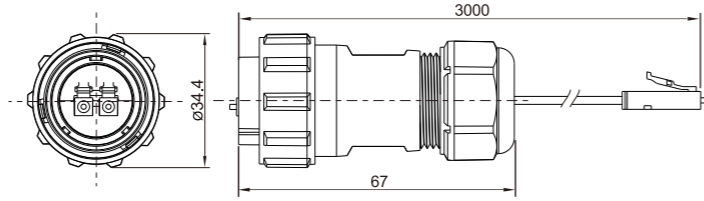

SY2510/PLC

Wire length:
0.5m
1.0m
1.5m
2.0m
3.0m

★ Wire length can be customized

SY25 Series



SY25



Plug with USB3.0 adapter
Mate with SY2511, SY2511C,
SY2512, SY2513, SY2515

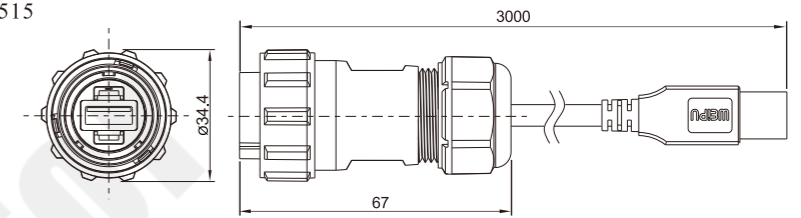

SY2510/PUSB3.0

Wire length:
0.5m
1.0m
1.5m
2.0m
3.0m

★ Wire length can be customized



Rreceptacle with LC adapter C
Mate with SY2510

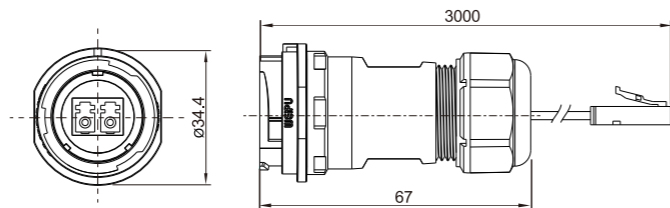

SY2511C/SLC

★ Wire length can be customized



Rreceptacle with USB3.0 adapter C
Mate with SY2510

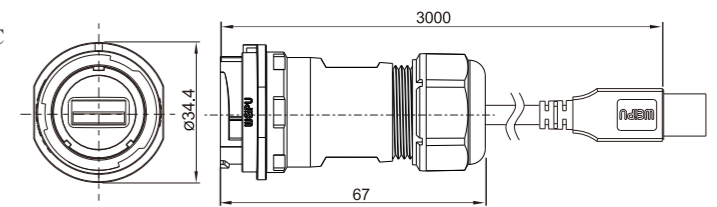

SY2511C/SUSB3.0

★ Wire length can be customized



Rear-nut mount receptacle
with LC adapter
Mate with SY2510

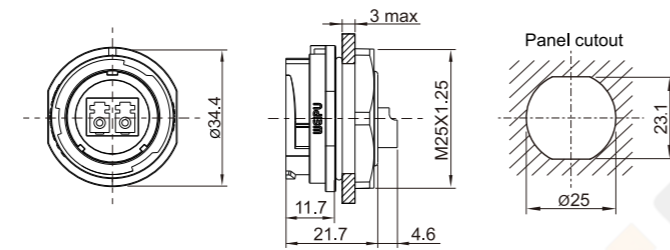

SY2512/SLC



Rear-nut mount receptacle
with USB3.0 adapter
Mate with SY2510

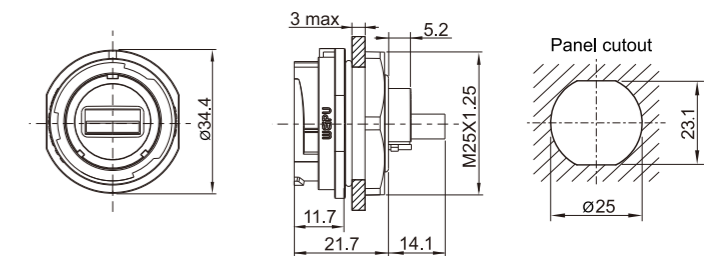

SY2512/SUSB3.0



2-hole flange
with LC adapter
Mate with SY2510

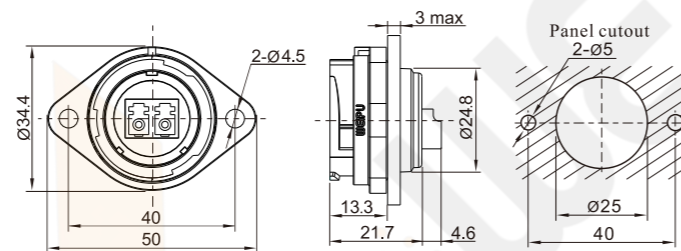

SY2513/SLC



2-hole flange
with USB3.0 adapter
Mate with SY2510

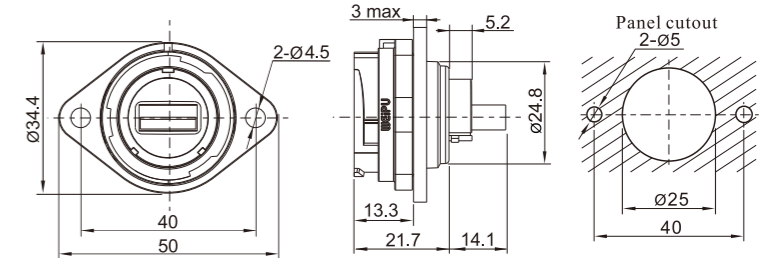

SY2513/SUSB3.0



Front-nut mount
with LC adapter
Mate with SY2510

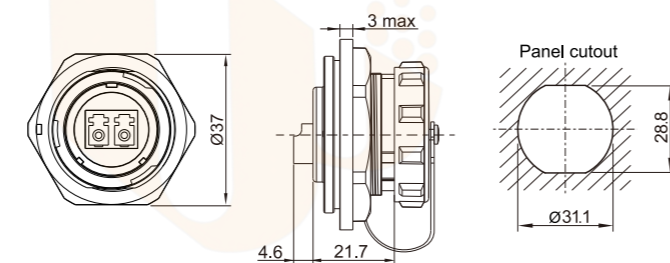

SY2515/SLC



Front-nut mount
with USB3.0 adapter
Mate with SY2510

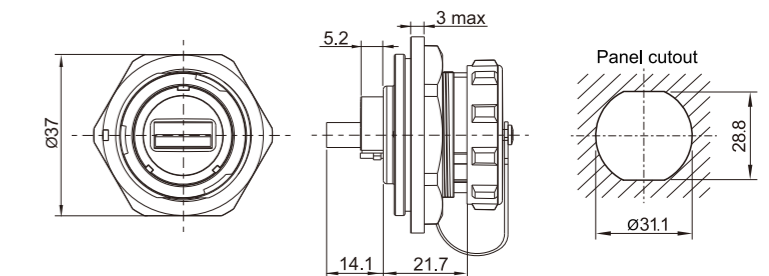

SY2515/SUSB3.0

SY25 Series



SY25



Plug with RJ45 adapter
Mate with SY2511, SY2511C,
SY2512, SY2513, SY2515

SY2510/PRJ45

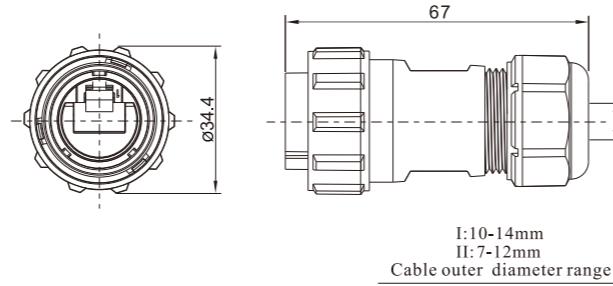

★ Wire length can be customized

SY25 Series



SY25



Plug with HDMI adapter
Mate with SY2511, SY2511C,
SY2512, SY2513, SY2515

SY2510/PHDMI2.0

Wire length:
0.5m
1.0m
1.5m
2.0m
3.0m

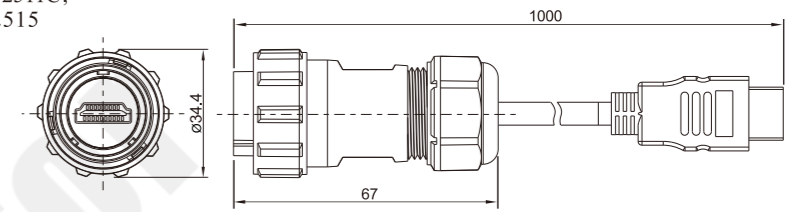

★ Wire length can be customized



Rreceptacle with RJ45 adapter C
Mate with SY2510

SY2511C/SRJ45

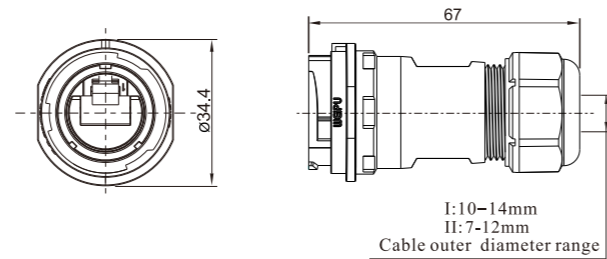

★ Wire length can be customized



Rreceptacle with
HDMI2.0 adapter C
Mate with SY2511, SY2511C,
SY2512, SY2513, SY2515

SY2511C/SHDMI2.0

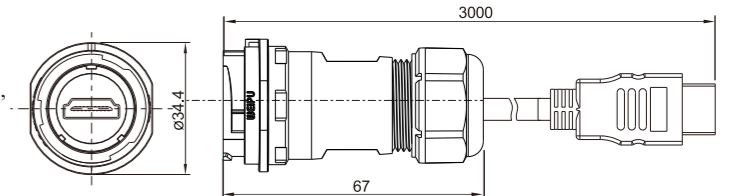

★ Wire length can be customized



Rear-nut mount receptacle
with RJ45 adapter
Mate with SY2510

SY2512/SRJ45

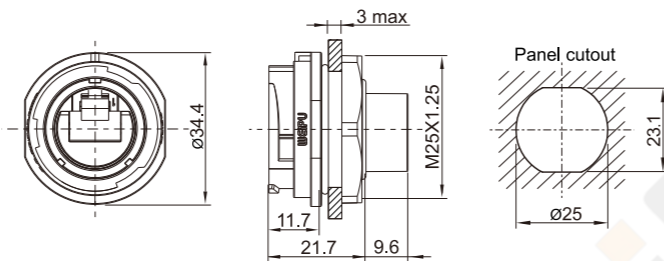

Rear-nut mount receptacle
with HDMI2.0 adapter
Mate with SY2510

SY2512/SHDMI2.0

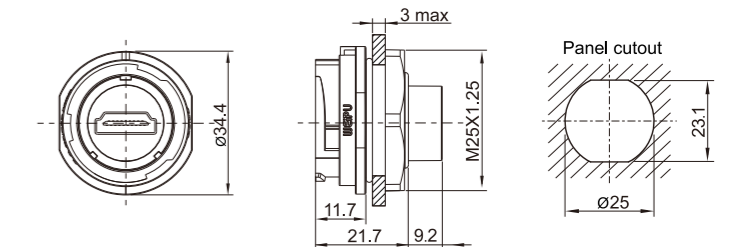

2-hole flange
with RJ45 adapter
Mate with SY2510

SY2513/SRJ45

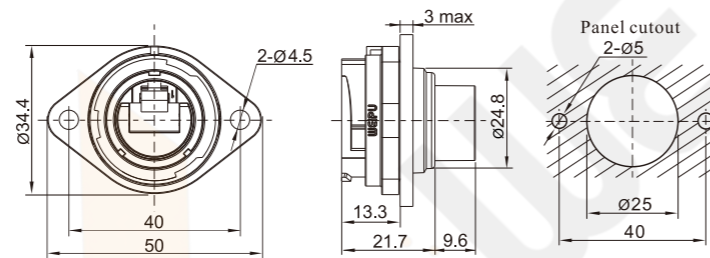

2-hole flange
with HDMI2.0 adapter
Mate with SY2510

SY2513/SHDMI2.0

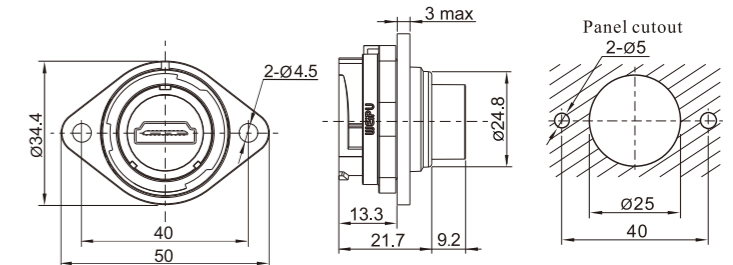

Front-nut mount
with RJ45 adapter
Mate with SY2510

SY2515/SRJ45

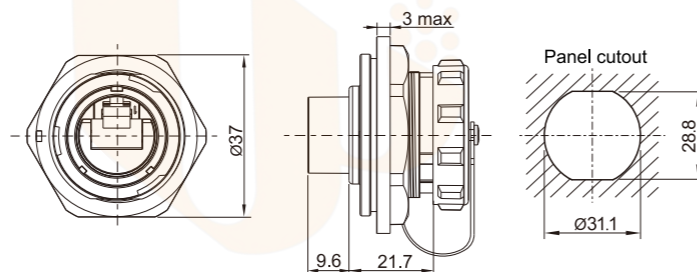

Front-nut mount
with HDMI2.0 adapter
Mate with SY2510

SY2515/SHDMI2.0

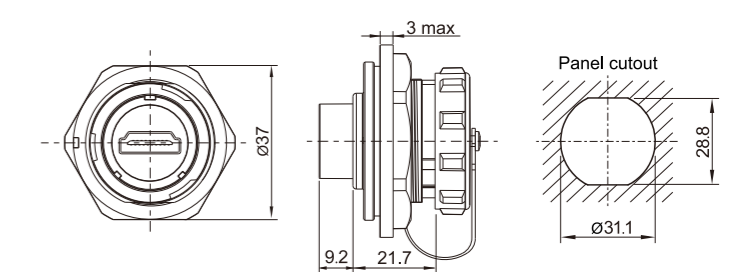

SY29 Series

**SY
29**



Cable connector
Mate with SY2911, SY2911C,
SY2912, SY2913

SY2910/P --- SY2910/S

Male contact
Female contact
Number of contact
1: solder, 2: screw, 3: crimp
I: 9-13mm II: 13-16mm
Cable outer diameter range

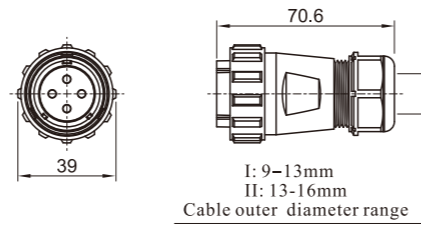

In-line cable connector C
Mate with SY2910

SY2911C/P --- SY2911C/S

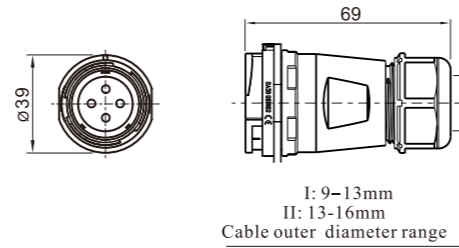

Rear-nut mount
Mate with SY2910

SY2912/P --- SY2912/S

1: solder, 2: screw, 3: crimp
Number of contact

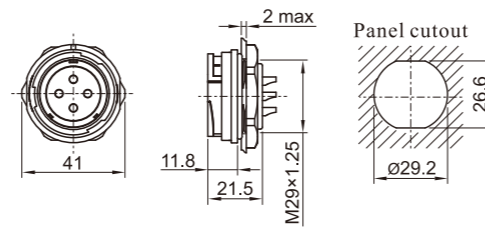

2-hole flange
Mate with SY2910

SY2913/P --- SY2913/S

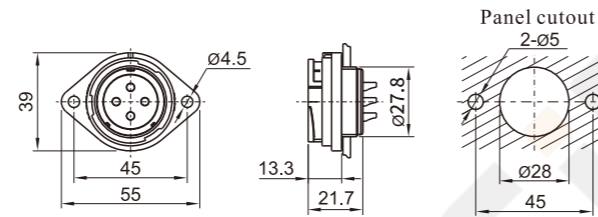

Solder contact spec

★Crimp contact spec see P20

★Screw contact spec see P21

Number of contact	2	3	4	7	8	8B	9	10	10B	12	16	17	20	24	26	35
Male contact face view																
Rated current (A)	50	50	25	25	25	60, 5	25, 5	25	10	10	10	10	5	5	5	5
Contact diameter(mm)	Ø3.5X2	Ø3.5X3	Ø2.5X4	Ø2.5X7	Ø2.5X8	Ø5X2 Ø1X6	Ø2.5X4 Ø1X5	Ø2.5X10	Ø1.5X10	Ø1.5X12	Ø1.5X16	Ø1.5X17	Ø1X20	Ø1X24	Ø1X26	Ø1X35
Rated voltage (AC.V)	500	500	500	500	500	500 400	500	500	500	500	500	500	400	400	400	400
Test voltage(AC.V) 1 min	1500	1500	1500	1500	1500	1500	1500	1500	1500	1500	1500	1500	1200	1200	1200	1200
Contact resistance(mΩ)	0.5	0.5	1	1	1	0.5, 5	1, 5	1	2.5	2.5	2.5	2.5	5	5	5	5
Termination	solder / screw	solder / screw	solder / screw	solder / screw	solder / screw	solder	solder	solder / screw	solder	solder	solder	solder	solder	solder	solder	solder
Wire size (mm ² /AWG)	≤10/7	≤10/7	≤4/11	≤4/11	≤4/11	≤16/5 ≤0.75/18	≤4/11 ≤0.75/18	≤4/11	≤2/14	≤2/14	≤2/14	≤2/14	≤0.75/18	≤0.75/18	≤0.75/18	≤0.75/18
Wire size for screw termination	≤6/10	≤6/10	≤1.5/15	≤1.5/15	≤1.5/15	/	/	≤1.5/15	/	/	/	/	/	/	/	/

